

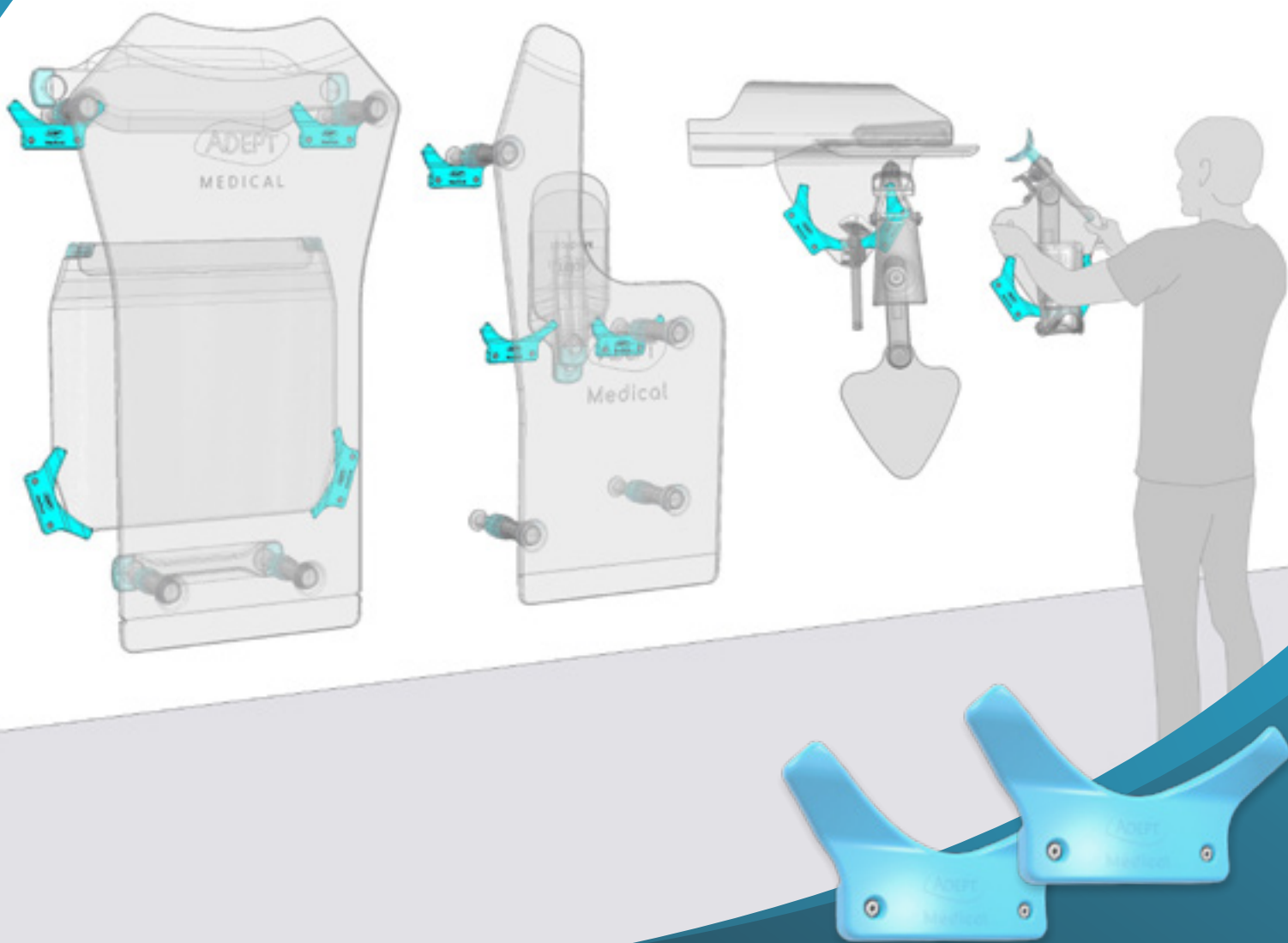

 | [adeptmedical.com](https://www.adeptmedical.com)

ADEPT

Medical
Supporting you



ADEPT MEDICAL STORAGE SYSTEM

A space-saving, storage solution
for the Adept Medical suite.

ADEPT MEDICAL STORAGE SYSTEM

A space-saving, storage solution for the Adept Medical suite

Custom-designed for your Adept Medical products, the Adept Medical Storage System is a low-profile, wall hanging solution to help organise your workspace with ease, speed and efficiency.

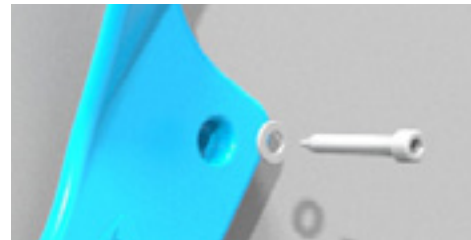

Offering the flexibility to mount equipment in-lab for easy access, or out of sight in another space, it streamlines the patient setup workflow, and post procedure tidy up.

Made from a robust plastic material, it is lightweight, easy to clean, and easily installed by screwing directly onto the wall.

The simple bracket system frees up floorspace, reduces tripping hazards, offers clear product visibility, and keeps your products safe.

Required Brackets (per product)

 **1x AM0001**
STARBoard + STARSupport
AM0100



 **1x AM0001**
STARSystem
AM0160

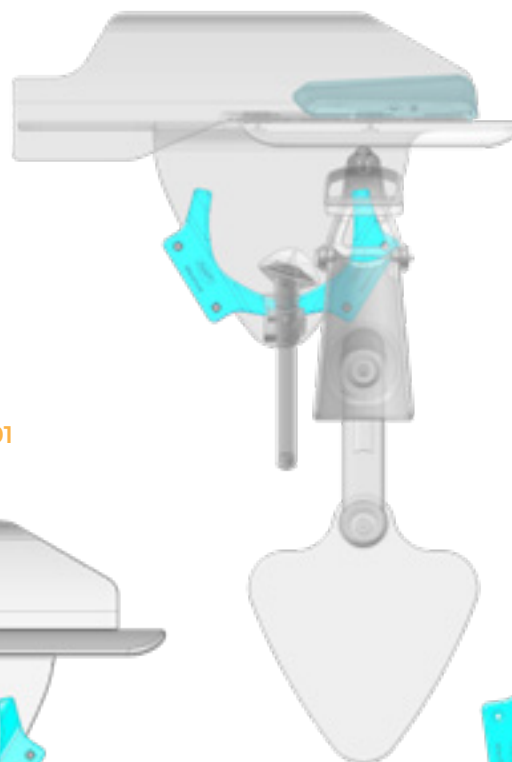

 **1x AM0001**
STARBoard + Extension Tray
AM0180

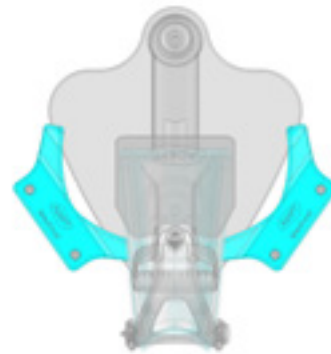

 **1x AM0001**
STARTable
AM0140



 **1x AM0001**
IR Shield
AM0500



 **1x AM0001**
Overhead Arm Support
AM4000

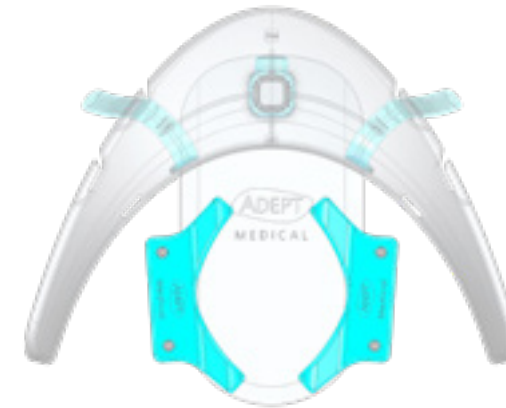

 **1x AM0001**
ArmSure + Shield
AM0610



 **1x AM0001**
Lower Leg Support
AM3000



 **1x AM0001**
ArmSure
AM0640

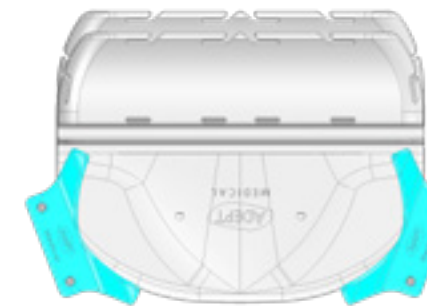

 **1x AM0001**
Prone Support
AM0700

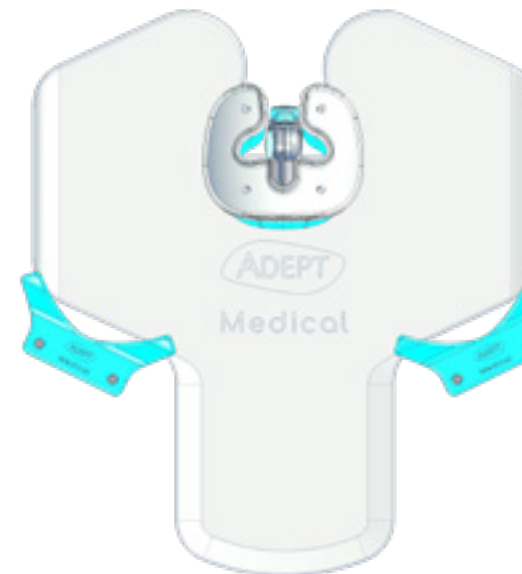

 **1x AM0001**
Clinician Arm Support
AM0900



 **1x AM0001**
Head Immobiliser
AM0800



 **1x AM0001**
Adducted Arm Scoop
AM1100



 **1x AM0001**
Drape Support
AM1000



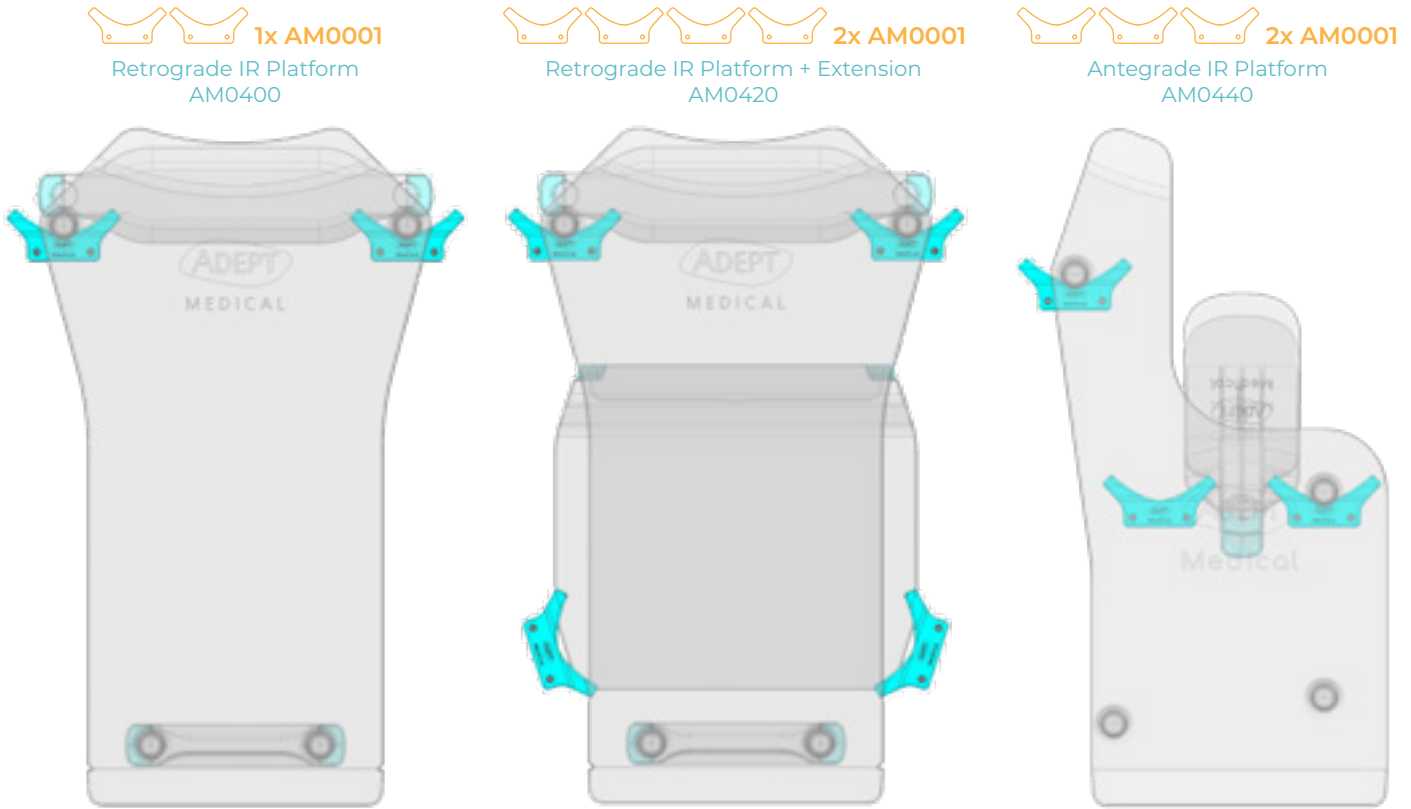

Disclaimer: Each AM0001 Adept Medical Storage System comes with x2 brackets. Screw fasteners not included. Brackets are intended for specified Adept Medical product use only. Mounting Template to be supplied with purchase. Installation to be performed by a suitably qualified person, following your internal facility protocols.

Key Features and Benefits

- | Simple hanging system
- | Easy to install
- | Allows convenient placement of equipment
- | Saves space in-lab
- | Helps keep equipment safe
- | Strong and durable
- | Easy to clean

Specifications

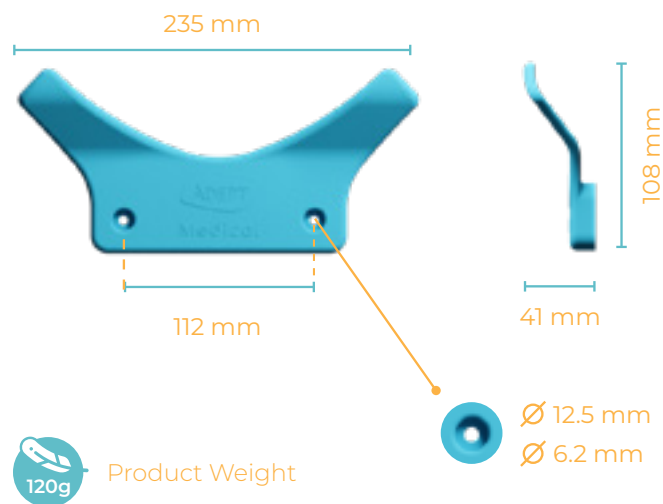

Manufacturer
 Adept Medical Ltd
 2-6 McDonald St,
 Morningside
 Auckland 1025, New Zealand